



Model Number

NCB8-18GM40-N0-V1

Features

- 8 mm flush
- Usable up to SIL 2 acc. to IEC 61508

Accessories

V1-W-N-2M-PUR

Female cordset, M12, 2-pin, NAMUR, PUR cable

V1-G

Female connector, M12, 4-pin, field attachable

V1-W

Female connector, M12, 4-pin, field attachable

EXG-18

Quick mounting bracket with dead stop

V1-G-N-2M-PUR

Female cordset, M12, 2-pin, NAMUR, PUR cable

BF 18

Mounting flange, 18 mm

Technical Data

General specifications

Switching function		Normally closed (NC)
Output type		NAMUR
Rated operating distance	s_n	8 mm
Installation		flush
Assured operating distance	s_a	0 ... 6.48 mm
Actual operating distance	s_r	7.2 ... 8.8 mm typ. 8 mm
Reduction factor r_{AI}		0.39
Reduction factor r_{CU}		0.36
Reduction factor r_{304}		0.71
Output type		2-wire

Nominal ratings

Nominal voltage	U_o	8.2 V (R_i approx. 1 k Ω)
Switching frequency	f	0 ... 1500 Hz
Hysteresis	H	1 ... 15 typ. 5 %
Reverse polarity protection		reverse polarity protected
Short-circuit protection		yes
Suitable for 2:1 technology		yes, Reverse polarity protection diode not required
Current consumption		
Measuring plate not detected		≥ 2.2 mA
Measuring plate detected		≤ 1 mA
Switching state indicator		Multihole-LED, yellow

Functional safety related parameters

MTTF _d	2660 a
Mission Time (T_M)	20 a
Diagnostic Coverage (DC)	0 %

Ambient conditions

Ambient temperature	-25 ... 100 °C (-13 ... 212 °F)
Storage temperature	-40 ... 100 °C (-40 ... 212 °F)

Mechanical specifications

Connection type	Connector plug M12 x 1, 4-pin
Housing material	Stainless steel 1.4305 / AISI 303
Sensing face	PBT
Degree of protection	IP66 / IP67

General information

Use in the hazardous area	see instruction manuals
Category	1G; 2G; 3G; 1D

Compliance with standards and directives

Standard conformity	
NAMUR	EN 60947-5-6:2000 IEC 60947-5-6:1999
Electromagnetic compatibility	NE 21:2007
Standards	EN 60947-5-2:2007 EN 60947-5-2/A1:2012 IEC 60947-5-2:2007 IEC 60947-5-2 AMD 1:2012

Approvals and certificates

EAC conformity	TR CU 012/2011
FM approval	
Control drawing	116-0165
UL approval	cULus Listed, General Purpose
CSA approval	cCSAus Listed, General Purpose
CCC approval	CCC approval / marking not required for products rated ≤ 36 V

Dimensions

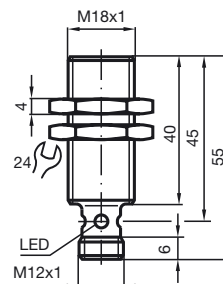

Electrical Connection

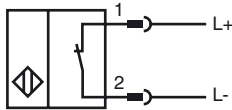

Pinout

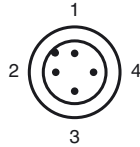

Wire colors in accordance with EN 60947-5-6

1	BN	(brown)
2	BU	(blue)

Equipment protection level Ga

CE marking	CE 0102	
ATEX marking	II 1G Ex ia IIC T6...T1 Ga The Ex-related marking can also be printed on the enclosed label.	
Standards	EN 60079-0:2012+A11:2013 EN 60079-11:2012 Ignition protection "Intrinsic safety" Use is restricted to the following stated conditions	
Appropriate type	NCB8-18GM...-N0...	
Effective internal inductivity	C_i	$\leq 120 \text{ nF}$; a cable length of 10 m is considered.
Effective internal inductance	L_i	$\leq 50 \text{ }\mu\text{H}$; a cable length of 10 m is considered.
Ambient temperature	Details of the correlation between the type of circuit connected, the maximum permissible ambient temperature, the temperature class, and the effective internal reactance values can be found on the EC-type examination certificate. Note: Use the temperature table for category 1 !!! The 20 % reduction in accordance with EN 1127-1 has already been applied to the temperature table for category 1.	

Equipment protection level Gb

CE marking	CE 0102	
ATEX marking	II 1G Ex ia IIC T6...T1 Ga The Ex-significant identification is on the enclosed adhesive label	
Standards	EN 60079-0:2012+A11:2013 EN 60079-11:2012 Ignition protection "Intrinsic safety" Use is restricted to the following stated conditions	
Appropriate type	NCB8-18GM...-N0...	
Effective internal inductivity	C_i	$\leq 120 \text{ nF}$; a cable length of 10 m is considered.
Effective internal inductance	L_i	$\leq 50 \text{ }\mu\text{H}$; a cable length of 10 m is considered.
Maximum permissible ambient temperature T_{amb}	Details of the correlation between the type of circuit connected, the maximum permissible ambient temperature, the temperature class, and the effective internal reactance values can be found on the EC-type examination certificate.	

Release date: 2018-04-19 08:14 Date of issue: 2018-04-19 181089_eng.xml

Equipment protection level Gc (ic)

Certificate	PF 13 CERT 2895 X
CE marking	CE
ATEX marking	⊕ II 3G Ex ic IIC T6...T1 Gc The Ex-significant identification is on the enclosed adhesive label
Standards	EN 60079-0:2012+A11:2013 EN 60079-11:2012 Ignition protection category "ic" Use is restricted to the following stated conditions
Effective internal inductivity C_i	≤ 120 nF ; a cable length of 10 m is considered.
Effective internal inductance L_i	≤ 50 μ H ; A cable length of 10 m is considered.

Special conditions

for $P_i=34$ mW, $I_i=25$ mA, T6	74 °C (165.2 °F)
for $P_i=34$ mW, $I_i=25$ mA, T5	89 °C (192.2 °F)
for $P_i=34$ mW, $I_i=25$ mA, T4-T1	100 °C (212 °F)
for $P_i=64$ mW, $I_i=25$ mA, T6	69 °C (156.2 °F)
for $P_i=64$ mW, $I_i=25$ mA, T5	84 °C (183.2 °F)
for $P_i=64$ mW, $I_i=25$ mA, T4-T1	100 °C (212 °F)
for $P_i=169$ mW, $I_i=52$ mA, T6	51 °C (123.8 °F)
for $P_i=169$ mW, $I_i=52$ mA, T5	66 °C (150.8 °F)
for $P_i=169$ mW, $I_i=52$ mA, T4-T1	74 °C (165.2 °F)
for $P_i=242$ mW, $I_i=76$ mA, T6	39 °C (102.2 °F)
for $P_i=242$ mW, $I_i=76$ mA, T5	52 °C (125.6 °F)
for $P_i=242$ mW, $I_i=76$ mA, T4-T1	52 °C (125.6 °F)

Equipment protection level Gc (nL)

Standard conformity	EN 60079-15:2003 Ignition protection category "n" Use is restricted to the following stated conditions
Effective internal capacitance C_i	≤ 120 nF ; a cable length of 10 m is considered.
Effective internal inductance L_i	≤ 50 μ H ; A cable length of 10 m is considered.

General

The apparatus has to be operated according to the appropriate data in the data sheet and in this instruction manual. The data stated in the data sheet are restricted by this operating instruction!
The special conditions must be observed!
The ATEX Directive applies only to the use of apparatus under atmospheric conditions.
If you use the device outside atmospheric conditions, consider that the permissible safety parameters should be reduced.

Special conditions

for $P_i=34$ mW, $I_i=25$ mA, T6	74 °C (165.2 °F)
for $P_i=34$ mW, $I_i=25$ mA, T5	89 °C (192.2 °F)
for $P_i=34$ mW, $I_i=25$ mA, T4-T1	100 °C (212 °F)
for $P_i=64$ mW, $I_i=25$ mA, T6	69 °C (156.2 °F)
for $P_i=64$ mW, $I_i=25$ mA, T5	84 °C (183.2 °F)
for $P_i=64$ mW, $I_i=25$ mA, T4-T1	100 °C (212 °F)
for $P_i=169$ mW, $I_i=52$ mA, T6	51 °C (123.8 °F)
for $P_i=169$ mW, $I_i=52$ mA, T5	66 °C (150.8 °F)
for $P_i=169$ mW, $I_i=52$ mA, T4-T1	74 °C (165.2 °F)
for $P_i=242$ mW, $I_i=76$ mA, T6	39 °C (102.2 °F)
for $P_i=242$ mW, $I_i=76$ mA, T5	52 °C (125.6 °F)
for $P_i=242$ mW, $I_i=76$ mA, T4-T1	52 °C (125.6 °F)

Equipment protection level Da

CE marking	CE 0102
ATEX marking	⊕ II 1D Ex ia IIIC T135°C Da The Ex-related marking can also be printed on the enclosed label.
Standards	EN 60079-0:2012+A11:2013 EN 60079-11:2012 Ignition protection "Intrinsic safety" Use is restricted to the following stated conditions
Appropriate type	NCB8-18GM...N0...
Effective internal inductivity C_i	≤ 120 nF A cable length of 10 m is considered.
Effective internal inductance L_i	≤ 50 μ H ; a cable length of 10 m is considered.
Maximum permissible ambient temperature T_{amb}	Details of the correlation between the type of circuit connected, the maximum permissible ambient temperature, the surface temperature, and the effective internal reactance values can be found on the EC-type-examination certificate. The maximum permissible ambient temperature of the data sheet must be noted, in addition, the lower of the two values must be maintained.